

# STANDARD

**CIAM**

## Pastry H750



### H750 Refrigerated / Pastry Counters

Monolithic AISI 304 stainless steel module | rounded internal edges | insulation with ecological water-based polyurethane | insulated cap | stainless steel wire rack for EN 60x40 trays | polished stainless steel doors with micro hinges and gaskets with magnetic closure | 100 mm frame support for versions with an external condensing unit and 350 mm support for those with built-in condensing unit | ventilated refrigeration | system with R452a gas and natural defrosting for versions with remote condensing unit | removable condenser dust filter for modules with built-in condensing unit | condensation drainage directly into the base of counter | electronic touch control unit | stainless steel plinth with height-adjustable feet



 +34/+46 °



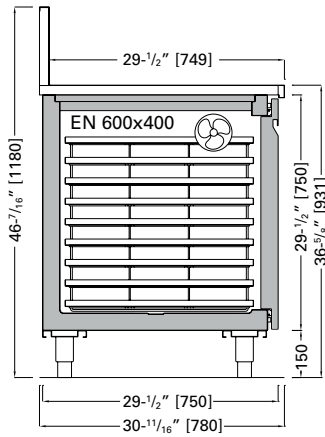

## Technical



- Ventilated
- R452a
- 1 / Hermetic
- Automatic / Hot Gas
- N.4 / R.H. 55% / 75°F
- 120 V / 1 ph / 60 Hz
- +34/+46 °F

## Data Sheet

\*Measurements are subject to revisions/updates, please refer to manufacturer's drawings at order confirmation



\*Crated dimensions and weight

Model	Dimensions	Weight	Max Pwr. Consumption	Avg Operating Consumption	Cooling Power/Expansion	GAS
Code	LxDxH - Inches	Lbs	W / A	KW/H	BTU / °F	Type
 SPBPMF1P7H7TI	34-7/16 X 30-11/16 X 46-7/16	132.28	210/1,5	0,15	511.82 / 3.2	R452a
	41-1/2 X 37-13/16 X 57-7/8	297.62 Cabinet + Crate				
 SPBPMF2P7H7TI	51-1/8 X 30-11/16 X 46-7/16	176.37	210/1,5	0,13	989.52 / 3.2	R452a
	58-1/4 X 37-13/16 X 57-7/8	407.85 Cabinet + Crate				
 SPBPMF3P7H7TI	71-7/8 X 30-11/16 X 46-7/16	231.48	290/2,2	0,18	1,364.86 / 3.2	R452a
	78-15/16 X 37-13/16 X 57-7/8	562.18 Cabinet + Crate				

\*\*Cabinet height measurement includes Type C countertop backsplash; Cabinet height without backsplash is 36-5/8" tall.

\*\*Overall length dimension may vary due to size of condensing unit tray. Please refer to manufacturer's drawings at order confirmation for final dimensions.

## Optionals:

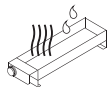

CSCR07  
Heated Evaporation Pan

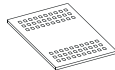

CSCR08  
Shelf with Perforations



CIR04F  
Plastic-Coated Grille

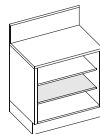

CIN20-23  
Intermediate Solid Shelf



CIM08  
Casters